



House and Land Package - Wollert Rathdowne — \$746,300.00



Wollert 3750

2003, Blackbuck Rd, VIC



This Package Inclusions :

- Tiles/Laminate flooring in living areas
- Led Downlights throughout the House
- Brick Infills above door and windows
- 900mm x 900mm Tiled Shower Base
- 2700mm high ceilings
- 2340mm high internal doors
- Stone benchtops for kitchen, bath and laundry
- Evaporative cooling and gas ducted heating
- 900mm appliances

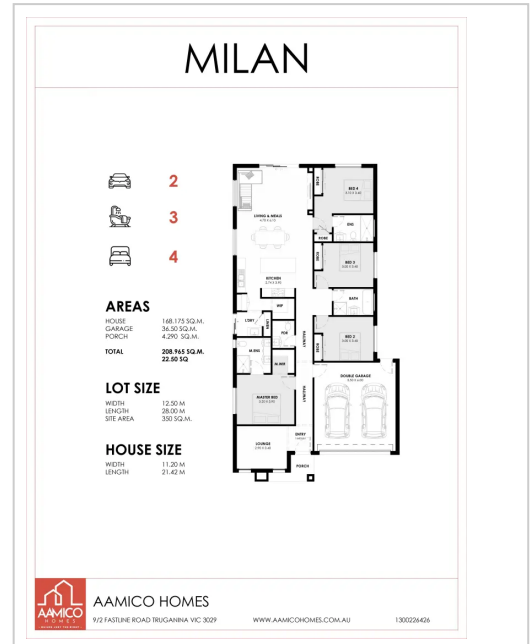

House and Land pricing based on developer engineering plans & plan of subdivision. Subject to developer and council approval. Price does not include any stamp duty, government, legal or bank charges. Alterations may incur additional charges. Refer to working drawings for specific locations and sizes. Aamico Homes reserves the right to withdraw or amend pricing, inclusions and promotions without notice. Bushfire (BAL) requirements will be credited back to the client if Aamico Homes receives confirmation that the house is not being constructed in a BAL-designated area. This cannot be confirmed until the site survey and property information from the relevant authorities are received.

Con Scalora

0401400002

Con@aamicohomes.com.au